

Land to the rear of
Firsby Avenue, Shirley



Scheme Overview



The proposal is for the creation of an access road to serve a small, but carefully designed residential development. Landscaping will be well considered in order to ensure an attractive environment and create a sense of space, not only for the occupiers of the development, but also for those who bound the site.

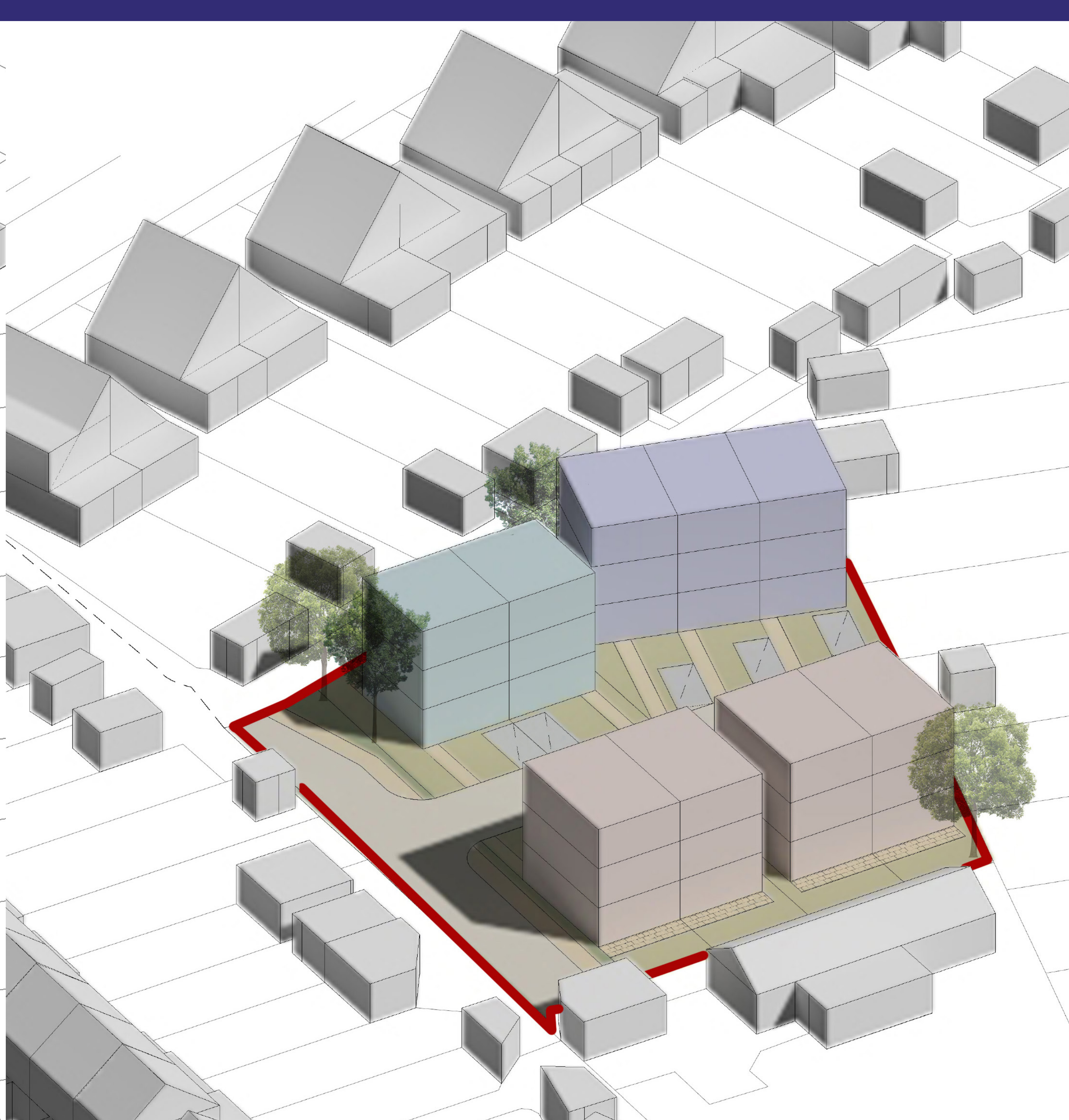

For further information, please contact:

Matthew Arnold on 020 8054 1438

matt.arnold@theoakwoodgroup.co.uk

www.theoakwoodgroup.co.uk

Land to the rear of
Firsby Avenue, Shirley

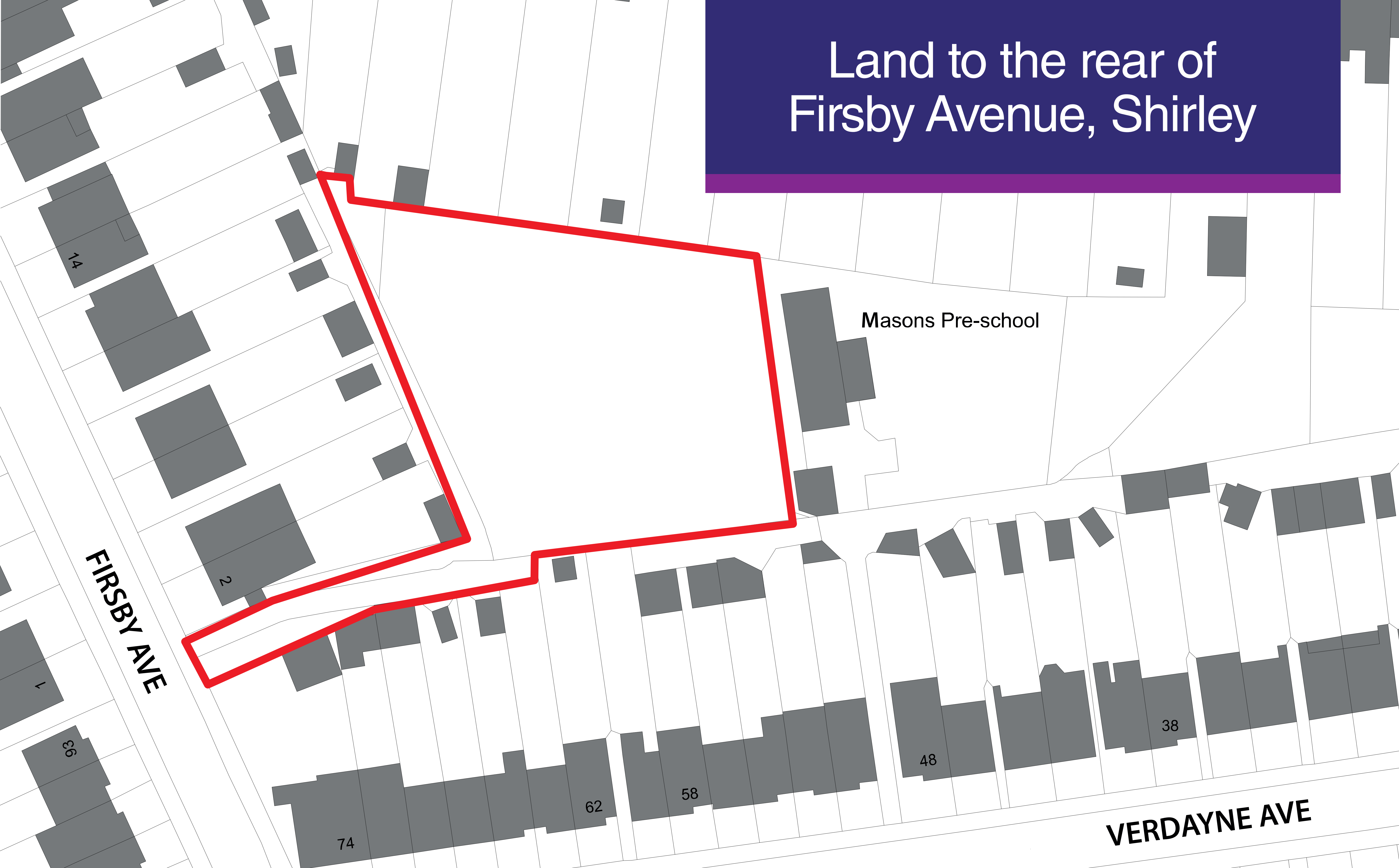

Existing Site Overview



The site is currently a vacant parcel of land which is located to the south of Firsby Avenue and to the east of Verdayne Avenue, Shirley.



For further information, please contact:

Matthew Arnold on 020 8054 1438

matt.arnold@theoakwoodgroup.co.uk

www.theoakwoodgroup.co.uk